

DATA SHEET

Ø 5.25 (XL K)

ROTARY VANE VACUUM PUMPS

oil-lubricated
air-cooled

MAKE IT BECKER.

COMPACT AND FLAT DESIGN

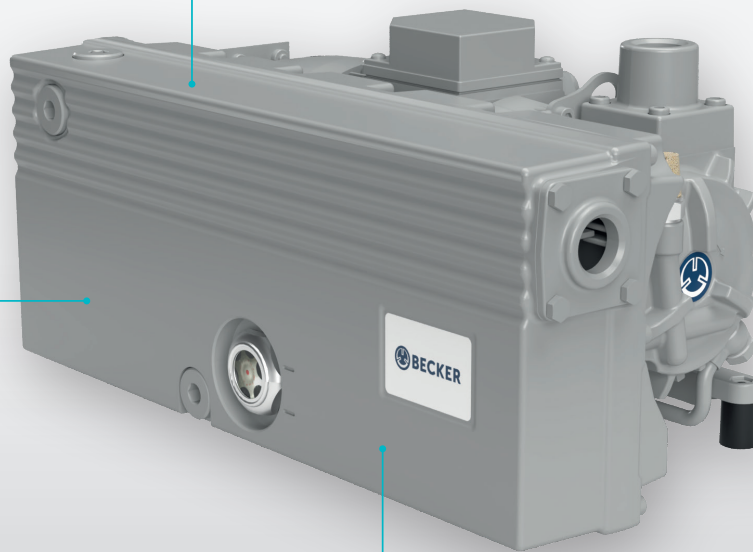

2 OIL TANK SIZES

MODULAR SYSTEM / VARIANTS

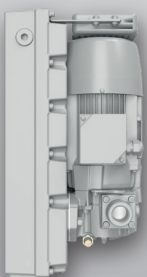

Ø 5.25 XL K

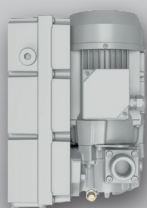

Ø 5.25



O 5.25 XL K WITH 1.0 L TANK AND OIL-AIR COOLER

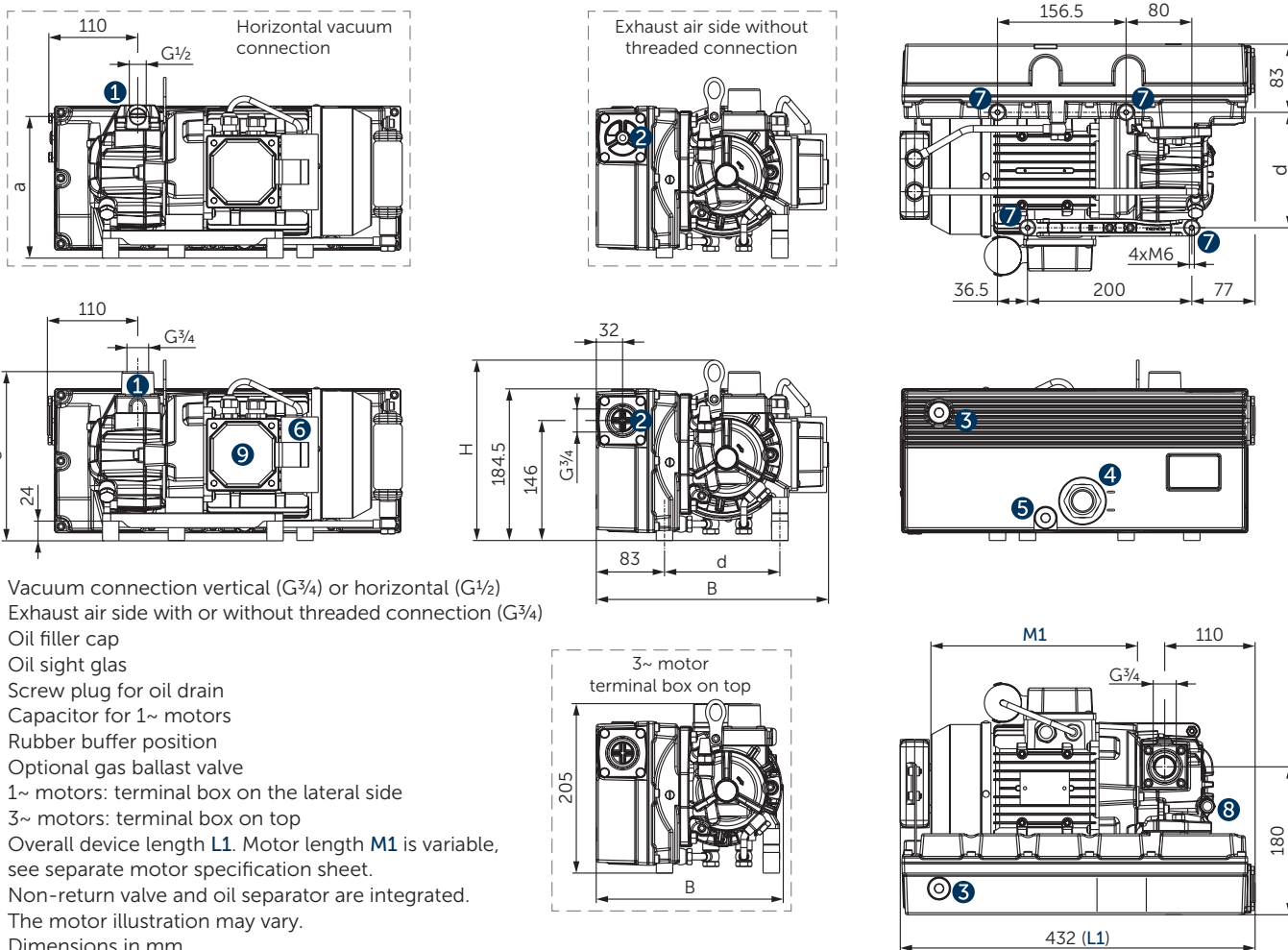

- 1 Vacuum connection vertical (G^{3/4}) or horizontal (G^{1/2})
 - 2 Exhaust air side with or without threaded connection (G^{3/4})
 - 3 Oil filler cap
 - 4 Oil sight glass
 - 5 Screw plug for oil drain
 - 6 Capacitor for 1~ motors
 - 7 Rubber buffer position
 - 8 Optional gas ballast valve
 - 9 1~ motors: terminal box on the lateral side
3~ motors: terminal box on top
- L Overall device length **L1**. Motor length **M1** is variable, see separate motor specification sheet.
- Non-return valve and oil separator are integrated.
 - The motor illustration may vary.
 - Dimensions in mm

Motor	a	B	c	d	H
1~	170.9	282.6	205.9	140.4	219.4
3~	169.4	227.5	204.4	129.9	211.0

	Nominal capacity		Vacuum absolute for continuous operation		Installed motor power		Emission sound pressure level ¹⁾		Weight incl. motor	Oil tank
	m ³ /h		mbar		kW		dB(A)		kg	l
	50 Hz	60 Hz	50 Hz	60 Hz	50 Hz	60 Hz	50 Hz	60 Hz		
O 5.25 XL K	26	30	2-300	2-300	0.75	0.9	63	63	≈24.5	1.0
O 5.25	26	30	2-100	2-100	0.75	0.9	63	66	≈22.0	0.5

¹⁾ According to DIN EN ISO 11203, accuracy class of measurement: class 2, extended measurement uncertainty: 3 dB
 1 m distance, at medium load, vacuum connection piped, exhaust side open
 ▪ Reference data (atmosphere): 1000 mbar, 20°C; tolerance: ±10%

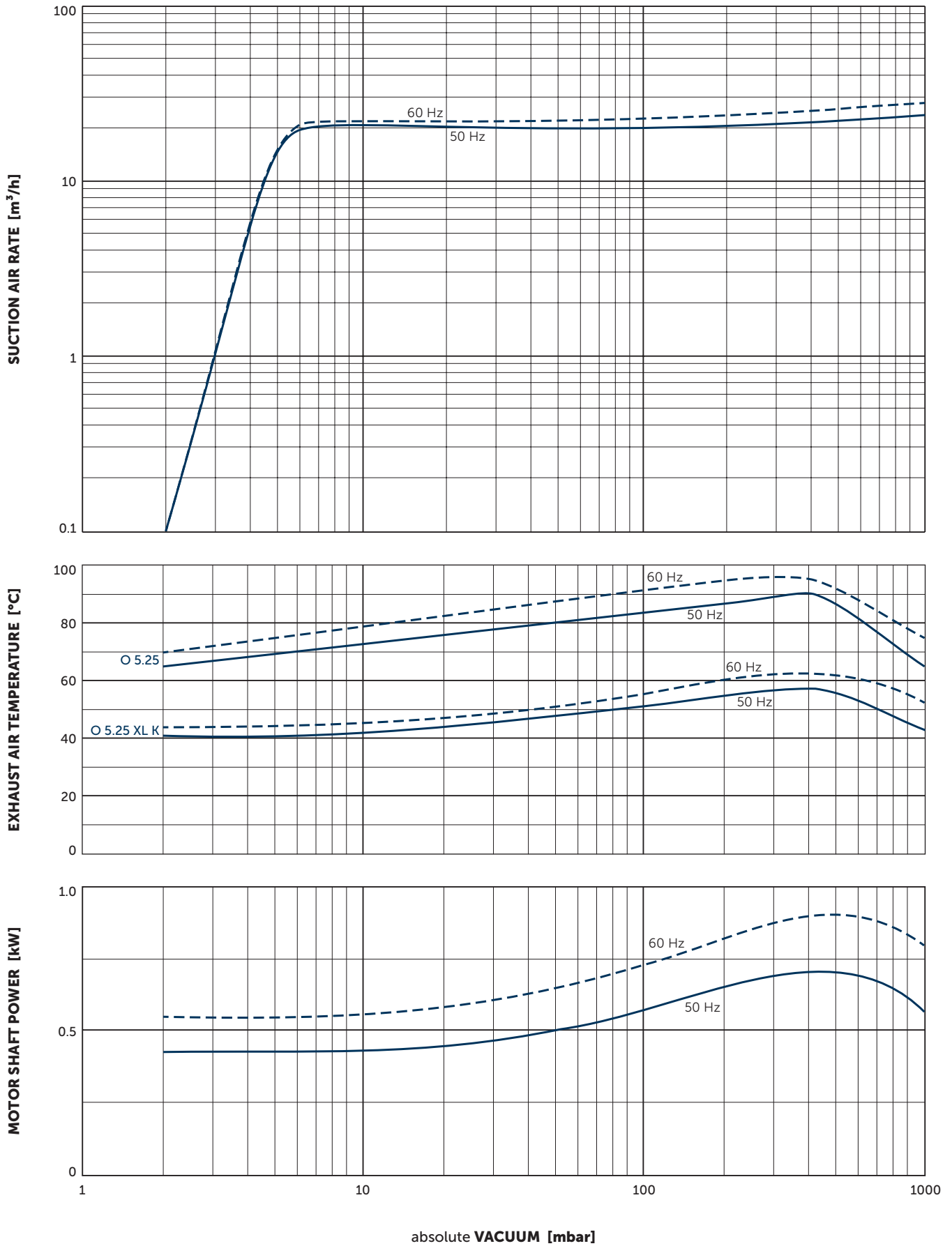

Suction air rate refers to the intake pressure
 Reference data (atmosphere): 1000 mbar, 20°C
 Tolerance: ±10%

+ VARIANTS AND ACCESSORIES

O 5.25 WITH 0.5 L TANK

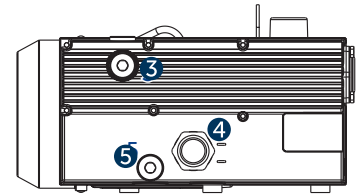
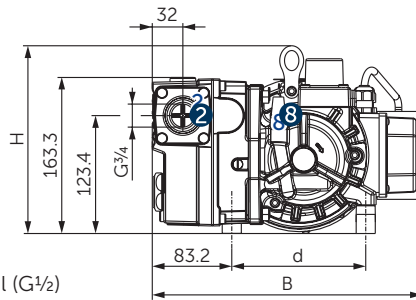
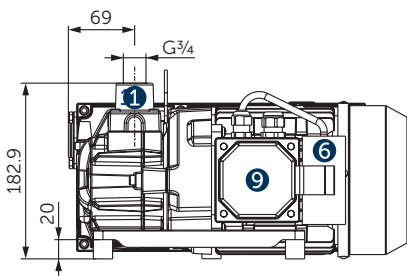
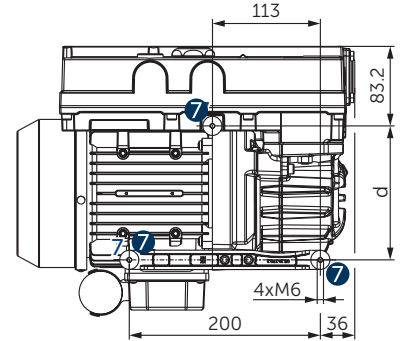
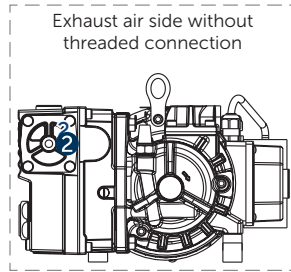
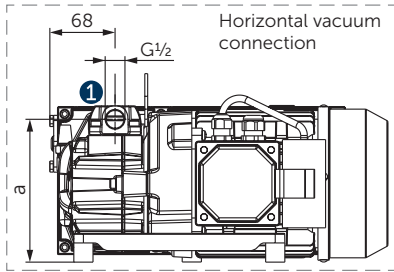

- 1 Vacuum connection vertical (G $\frac{3}{4}$) or horizontal (G $\frac{1}{2}$)
- 2 Exhaust air side with or without threaded connection (G $\frac{3}{4}$)
- 3 Oil filler cap
- 4 Oil sight glass
- 5 Screw plug for oil drain
- 6 Capacitor for 1~ motors
- 7 Rubber buffer position
- 8 Optional gas ballast valve
- 9 1~ motors: terminal box on the lateral side
3~ motors: terminal box on top

L Overall device length **L1** with motor. **L1** and **M1** are variable, see separate motor specification sheet.

- Non-return valve and oil separator are integrated.
- The motor illustration may vary.
- Dimensions in mm

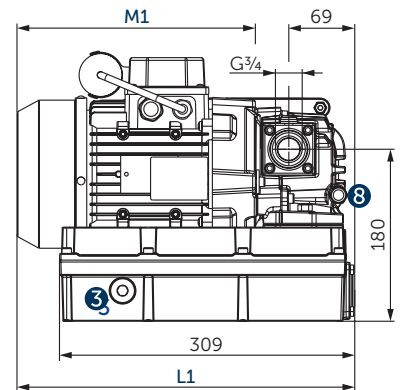
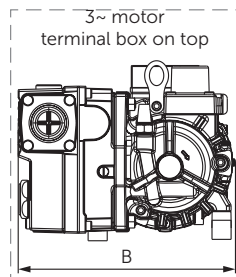

Motor	a	B	d	H	L1
1~	148.9	282.6	140.2	196.4	353.5
3~	147.4	227.5	129.7	188.4	320.5

O 5.25 WITH 0.5 L TANK AND MATE-N-LOK POWER CONNECTION

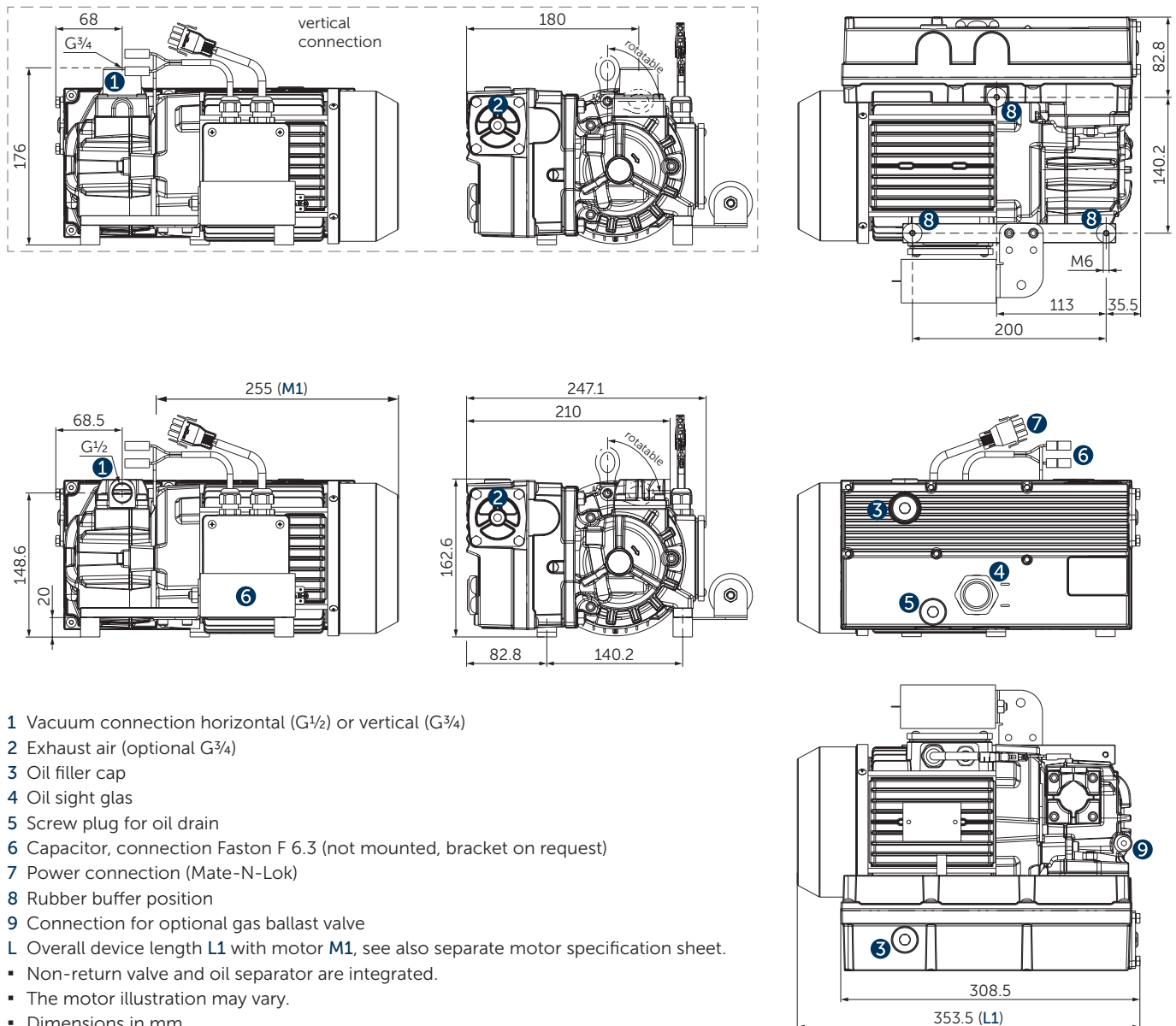

- 1 Vacuum connection horizontal (G $\frac{1}{2}$) or vertical (G $\frac{3}{4}$)
 - 2 Exhaust air (optional G $\frac{3}{4}$)
 - 3 Oil filler cap
 - 4 Oil sight glass
 - 5 Screw plug for oil drain
 - 6 Capacitor, connection Faston F 6.3 (not mounted, bracket on request)
 - 7 Power connection (Mate-N-Lok)
 - 8 Rubber buffer position
 - 9 Connection for optional gas ballast valve
- L Overall device length **L1** with motor **M1**, see also separate motor specification sheet.
- Non-return valve and oil separator are integrated.
 - The motor illustration may vary.
 - Dimensions in mm

ACCESSORIES

- Gas ballast valve
 - Version for small amounts of moisture, vacuum <3 mbar
 - Version for higher amounts of moisture, vacuum <20 mbar
- Oil **Becker Lube** ¹⁾
 - **M 68** mineral / **S 68** synthetic / **SL 68** food (food packaging) / **SM 68** food (food processing)
 - **M 32** mineral / **S 32** synthetic / **SL 32** food (food packaging) / **SM 32** food (food processing)
- Level sensor (oil level switch) ²⁾
 - **ST 628-0-22** (for 0.5 litre oil tank)
 - **ST 628-0-23** (for 1.0 litre oil tank)



¹⁾ See operating instructions

²⁾ Only for vertical installation



MAKE IT BECKER.

HOMEPAGE
[O SERIES](#)



DOWNLOAD
[MOTOR SPECS.](#)



ONLINE SHOP

